

VIBRAMAT

Dry Areas Direct Stick Installation

Mapei System for Typical Ceramic Tiles and Stone Installations

- A) Vibramat Acoustic Underlay T3mm, T4mm, T5mm, T10mm
- B) Mapei Eco 4 VSP, for non- absorbent substrates Mapei Ultrabond Eco S955 is recommended.
- C) Mapei Keraflex Maxi S1 for Ceramic Tiles for Sensitive Stones it is recommended that Mapecem Pronto screed is used between the Vibramat & the stone Granirapid adhesive should be used to adhere sensitive stone.
- D) Ceramic Tiles or Stone.

All Mapei products carry a full 10 year product warranty for further information please Contact Mapei at +617 3276 5000 or your Local Account Manager.

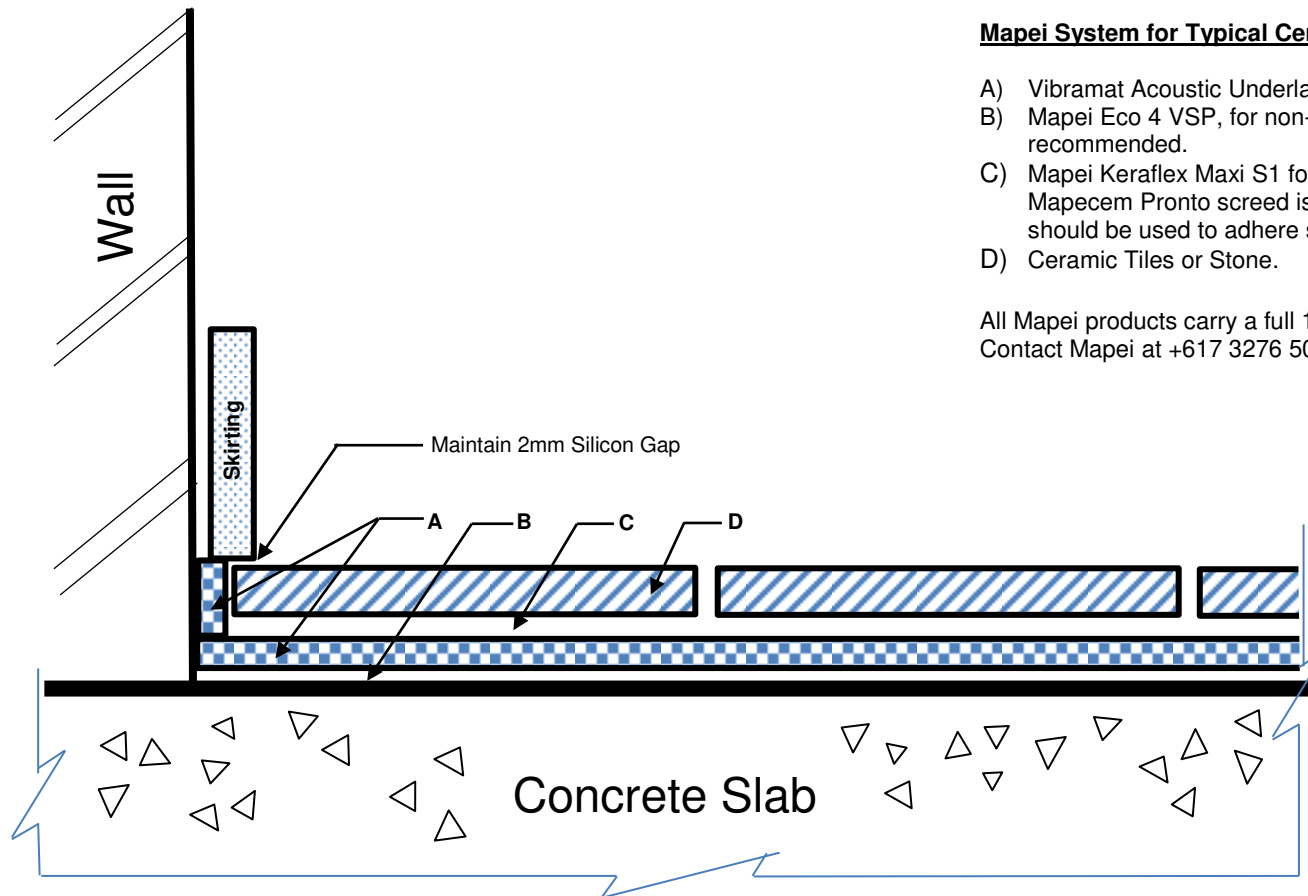

This diagram is for illustrative purposes only and is not to scale

VIBRAMAT

Dry Area Bonded Screed Installation

Mapei System for Typical Ceramic and Stone Installations

- A) Vibramat Acoustic Underlay T3mm, T4mm, T5mm, T10mm
- B) Mapei Eco 4 VSP, for non- absorbent substrates Mapei Ultrabond Eco S955 is recommended.
- C) Sand & Cement Screed with Mapei Planicrete SP 3:1 - minimum thickness of screed to a minimum thickness of 25mm. For all non-absorbent substrates it is recommended that Mapecem Pronto be used.
- D) Mapei Keraflex for Ceramic Tiles or Granirapid for Moisture Sensitive Stone or Tiles.
- E) Ceramic Tiles / Stone.

All Mapei products carry a full 10 year product warranty for further information please Contact Mapei at +617 3276 5000 or your Local Account Manager.

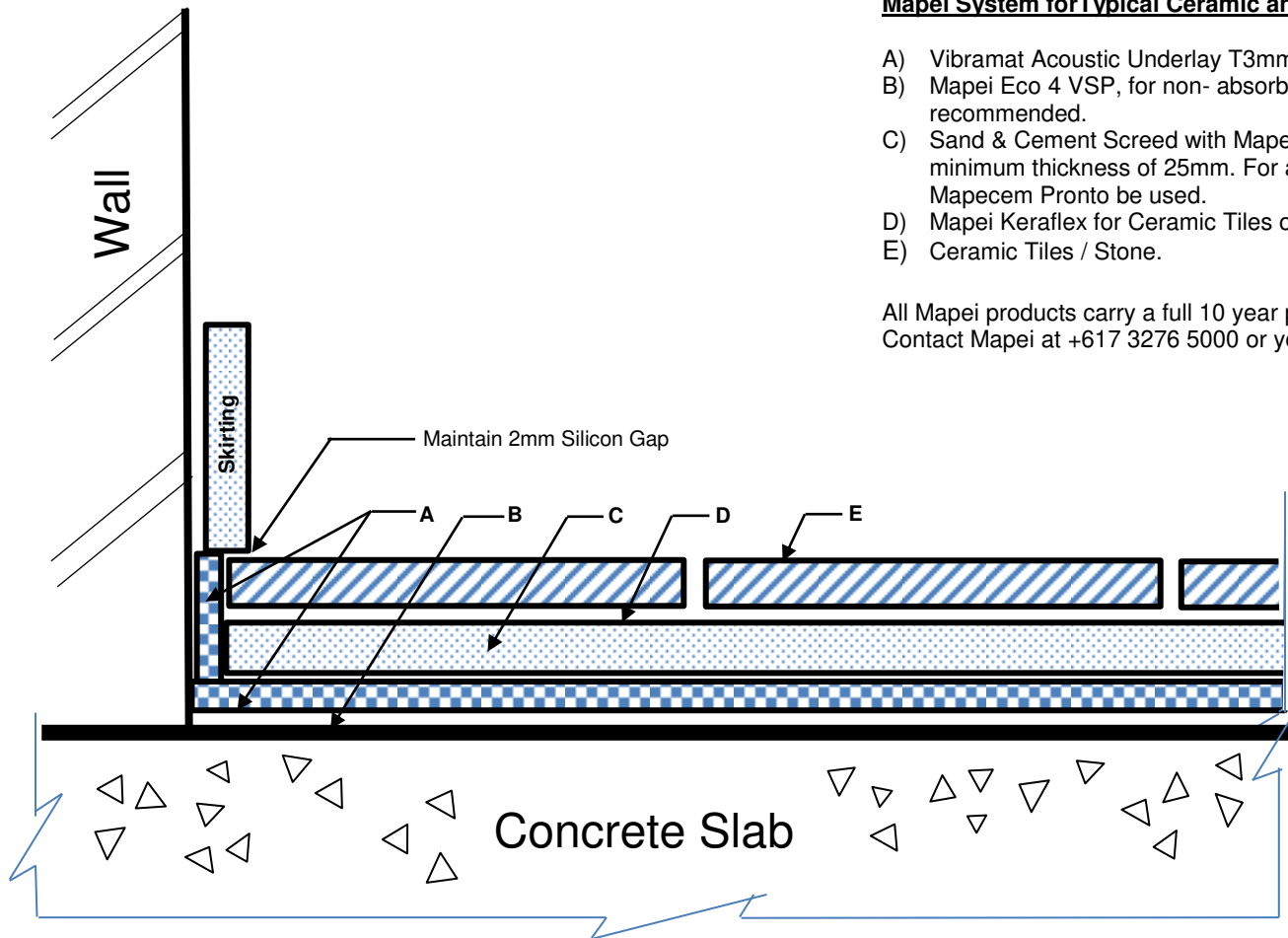

This diagram is for illustrative purposes only and is not to scale

VIBRAMAT

Wet Area Tiling over Unbonded Screed Waterproofing below & above the Acoustic Underlay

Mapei System for Typical Ceramic Tiles and Stone Installations

- A) Waterproofing membrane - Mapelastic Smart or Aqua Defense
- B) Vibramat Acoustic Underlay T3mm, T4mm, T5mm, T10mm loose laid over waterproofing membrane.
- C) Sand & Cement Screed – minimum thickness 35mm at its lowest point. Or the use of Mapecem Pronto is recommended.
- D) Waterproofing membrane – Mapelastic Smart or Aqua Defense.
- E) .Prepare Vibramat Underlay to ensure tight butt joints. If necessary tack with some silicone to ensure that the joints do not come apart during the screeding process.
- F) Mapei Keraflex for Ceramic Tiles or Mapei Granirapid for Moisture Sensitive Stones.
- G) Mapeflex PU-45 Bond Breaker.

All Mapei products carry a full 10 year product warranty for further information please Contact Mapei at +617 3276 5000 or your Local Account Manager.

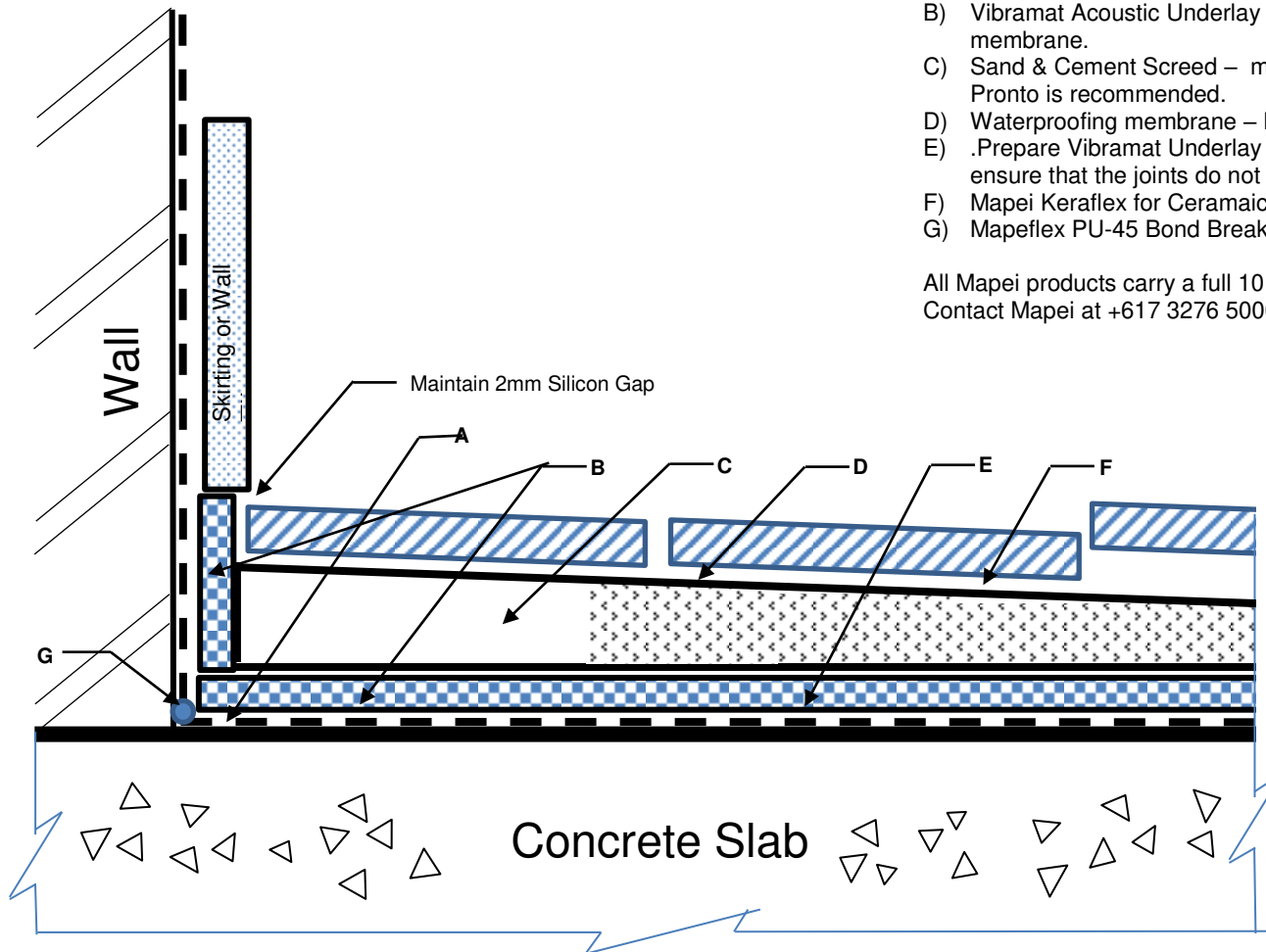

This diagram is for illustrative purposes only and is not to scale

VIBRAMAT

Wet Area Tiling over Bonded Screed Waterproofing below & above the Acoustic Underlay

Mapei System for Typical Ceramic Tiles and Stone Installations

- A) Waterproofing Membrane – Mapelastic Smart or Aqua Defense.
- B) Mapei P990, on non- absorbent substrates Mapei Ultrabond Eco S955 is recommended.
- C) Vibramat Acoustic Underlay T3mm, T4mm, T5mm, T10mm
- D) Sand & Cement Screed– minimum thickness of screed 35mm. Or the use of Mapecem Pronto is recommended.
- E) Waterproofing Membrane – Maplesatic Smart or Aqua Defense.
- F) Mapei Keraflex for Ceramic Tiles or Mapei Granirapid for Moisture Sensitive Stones.
- G) Mapeflex PU-45 Bond Breaker.

All Mapei products carry a full 10 year product warranty for further information please Contact Mapei at +617 3276 5000 or your Local Account Manager.

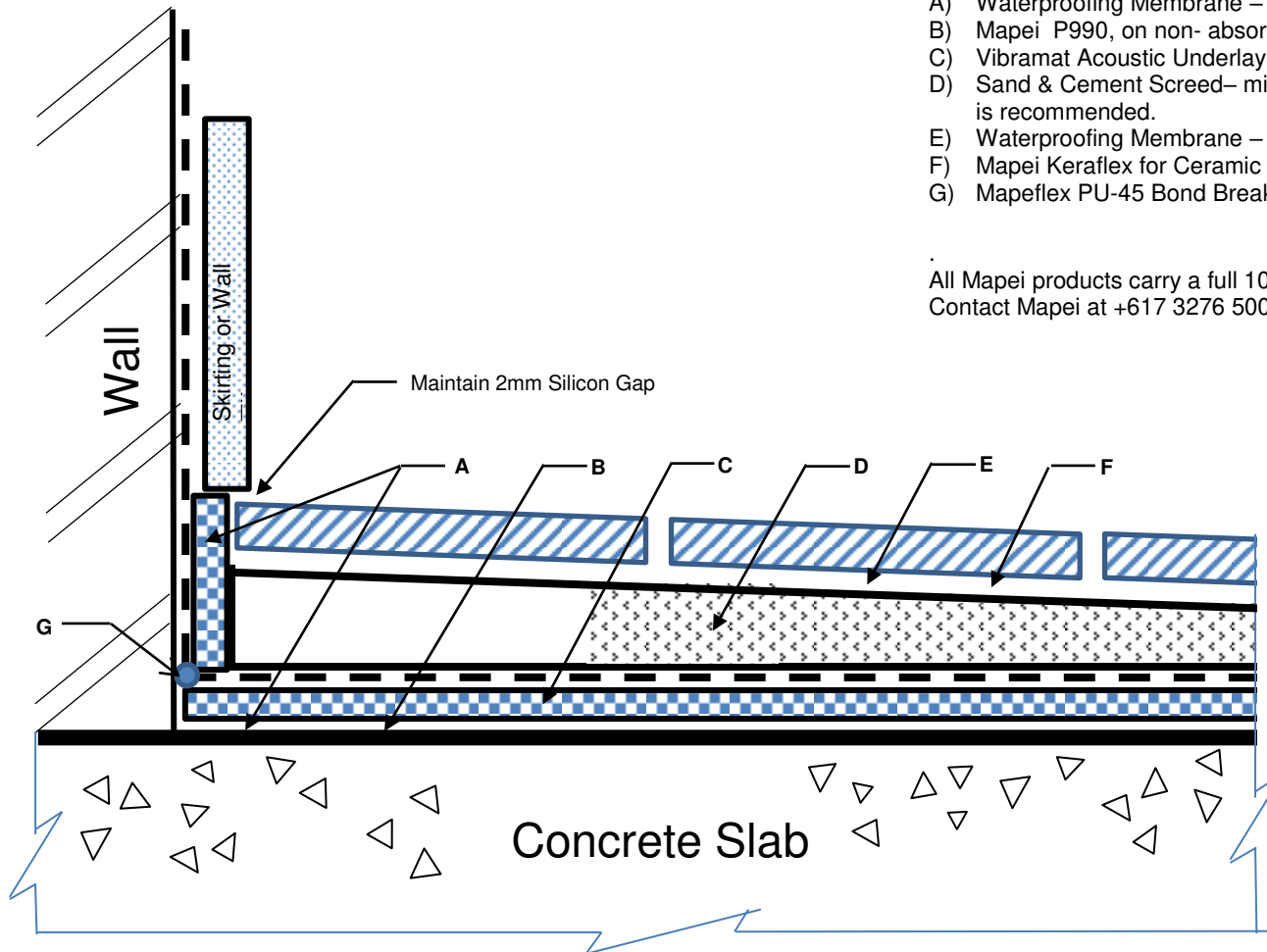

This diagram is for illustrative purposes only and is not to scale

VIBRAMAT

Wet Area Direct Stick

Waterproofing above the Acoustic Underlay

Mapei System for Typical Tiles and Stone -

- A) Mapei P990, on non- absorbent substrates Mapei Ultrabond Eco S955 is recommended
- B) Vibramat Acoustic Underlay T3mm, T4mm, T5mm
- C) Waterproofing Membrane- Mapelastic Smart or Aqua Defense.
- D) Mapei Keraflex Maxi S1 / Kerabond Plus / Isolastic 50 for Ceramic Tiles or Mapei Granirapid for Moisture Sensitive Stones it is also recommended to screed with Mapecem Pronto above the Vibramat.
- E) Mapeflex PU-45 Bond Breaker.
- F) Tile or Stone.

Please Note: Screeding can also be carried out above or below the Acoustic Underlay

All Mapei products carry a full 10 year product warranty for further information please Contact Mapei at +617 3276 5000 or your Local Account Manager.

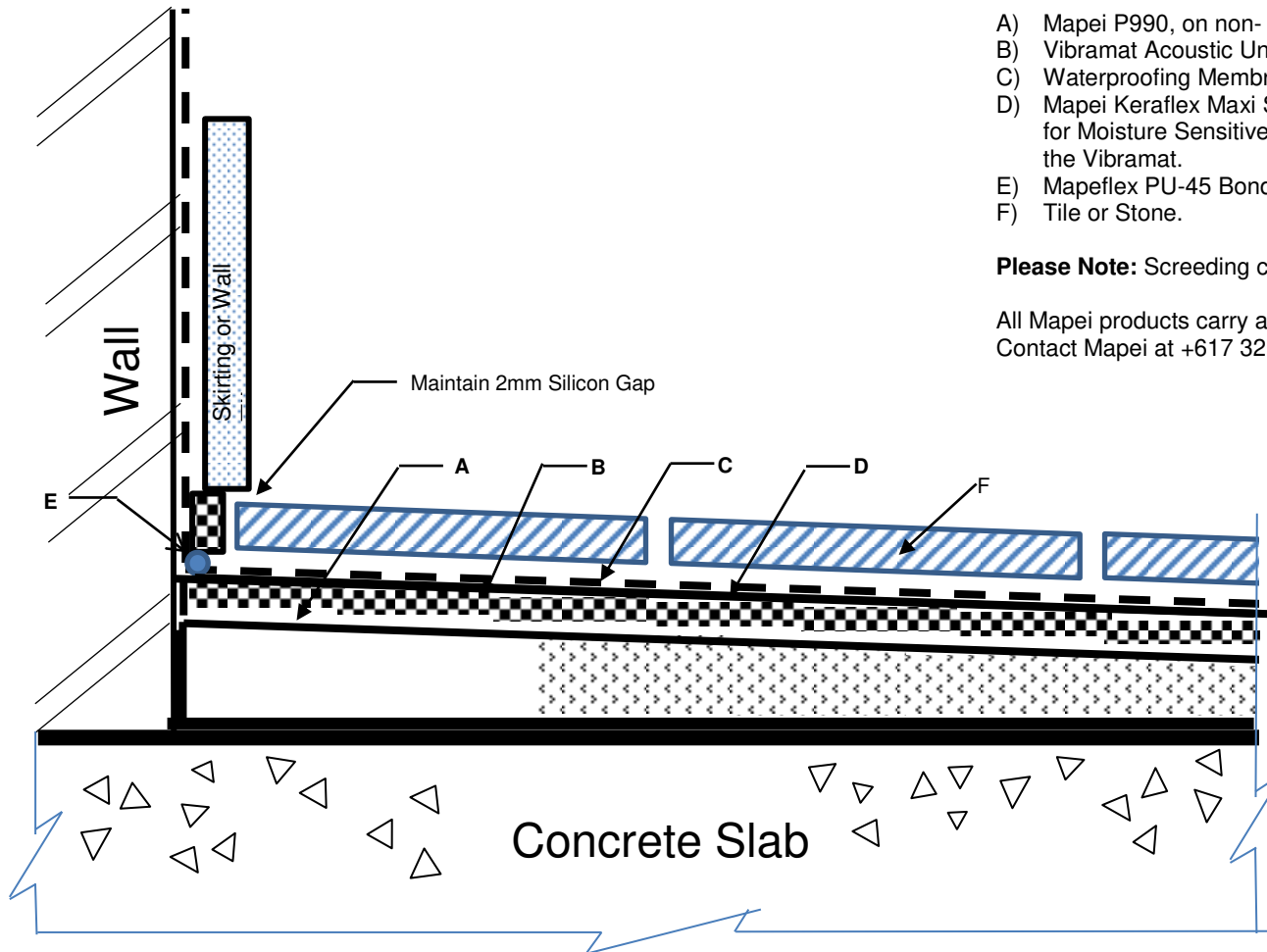

This diagram is for illustrative purposes only and is not to scale